

C Series

INDUSTRIAL SECTIONAL DOOR OPERATOR

C500

C500 Features The C500 motor drive unit adopts a servo motor combined with a two-stage reduction system, consisting of a gear reducer and a worm reducer, delivering high transmission efficiency and enhanced operational safety. Equipped with a auto/manual gear switching mechanism, providing greater convenience and safety during manual operation.

C500 Certifications

CE Certificate Standards

EN 12978:2003+A1:2009, EN 60204-1:2018,
EN IEC 61000-6-2:2019, EN IEC 61000-6-4:2019

Related to CE Directive(s)

2014/35/EU (Low Voltage)
2014/30/EU (Electromagnetic Compatibility)



C500 Details

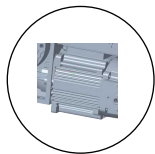

Rare-Earth Permanent Magnet Motor

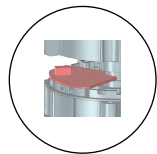

Electronic Limit with Absolute Encoder

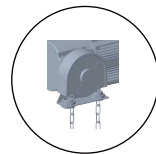

Emergency Manual Operating Device

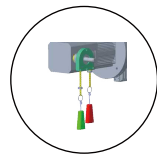

Auto/Manual Gear Switching Device



Two-stage Reduction Mechanism

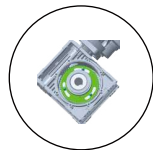

Worm Reducer with Built-in Safety Anti-falling Device

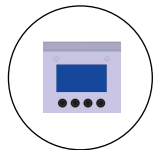

3-inch LCD Screen with Four Function Keys

C500 Motor Specifications



Model	C500
Motor Type	Servo Motor (PMSM)
Working System	S3
Motor Power (W)	1500
Power Supply (V)	1N-220V±10%
Frequency (Hz)	50/60
Current (A)	13
Output Speed (rpm) ¹⁾	4-16
Output Torque	500
Door Weight (kg) ²⁾	1600
Motor Ip Level	54
Working Environment (°C)	-20~+50
Hollow Shaft (mm)	31.75/40
Incremental Encoder	✓
Absolute Encoder (Built-In)	✓
Electronic Mechanical Brake	✓
Safety Anti-falling Device	✓
Hand Chain Length (m)	8
Cables Length (m)	9
Recommended Cycles Per Hour	3
Weight (kg)	34.5
Dimension (mm)	637.9 x 268.4 x 247.6

Value marked in color indicate customizable options.

- (1) Factory default speed: 12 rpm; Maximum speed at rated power: 12 rpm;
- (2) The weight of door per square meter is calculated as 16kg/㎡ (This value is for reference only due to the excessive variables in the sectional door counterweight system.)

